

# FOR LEASE - OFFICE

Miller Textile Building | NE Minneapolis  
861 Hennepin Ave E, Minneapolis, MN 55414



## Property Highlights

- Concrete, stone & timber construction
- Abundant natural light with new windows & openings
- 1,565-6,051 SF options available
- Brand new building mechanicals
- Ample Parking: 80+ Stalls of off street, surface parking
- One of the busiest corridors in NE: 14,500 vehicles per day
- 12' - 14' tall ceilings
- Available Now!

## Area Highlights

- Most accessible location in Northeast!
- A five minute walk to popular Northeast restaurants & amenities
- Bike lanes & transit options on your doorstep
- Located within 1/4 mile of I-35W
- Conveniently located between the U of M, Downtown, Northeast and North Loop

**MILLER**  
**TEXTILE**  
EST. 1886  
861 HENNEPIN AVE x NE MINNEAPOLIS

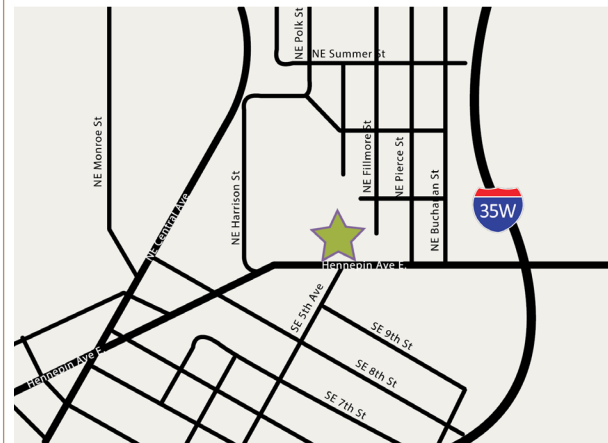

The information contained herein was obtained from sources believed to be reliable. However, The Ackerberg Group has not verified, nor have any knowledge regarding the accuracy or completeness of information, and make no representation or warranty concerning same. Therefore, The Ackerberg Group disclaims all liabilities in connection with any inaccuracies or incompleteness.

**Ronald R. Scholder**

Direct 612.877.4010

Email [RScholder@ackerberg.com](mailto:RScholder@ackerberg.com)

**Aaron Meyers**

Direct 612.924.6401

Email [Aaron@ackerberg.com](mailto:Aaron@ackerberg.com)



**ACKERBERG**  
[www.ackerberg.com](http://www.ackerberg.com)



## 3D Tenant Rendering



East Facade, From Parking Lot





# First Floor Plan

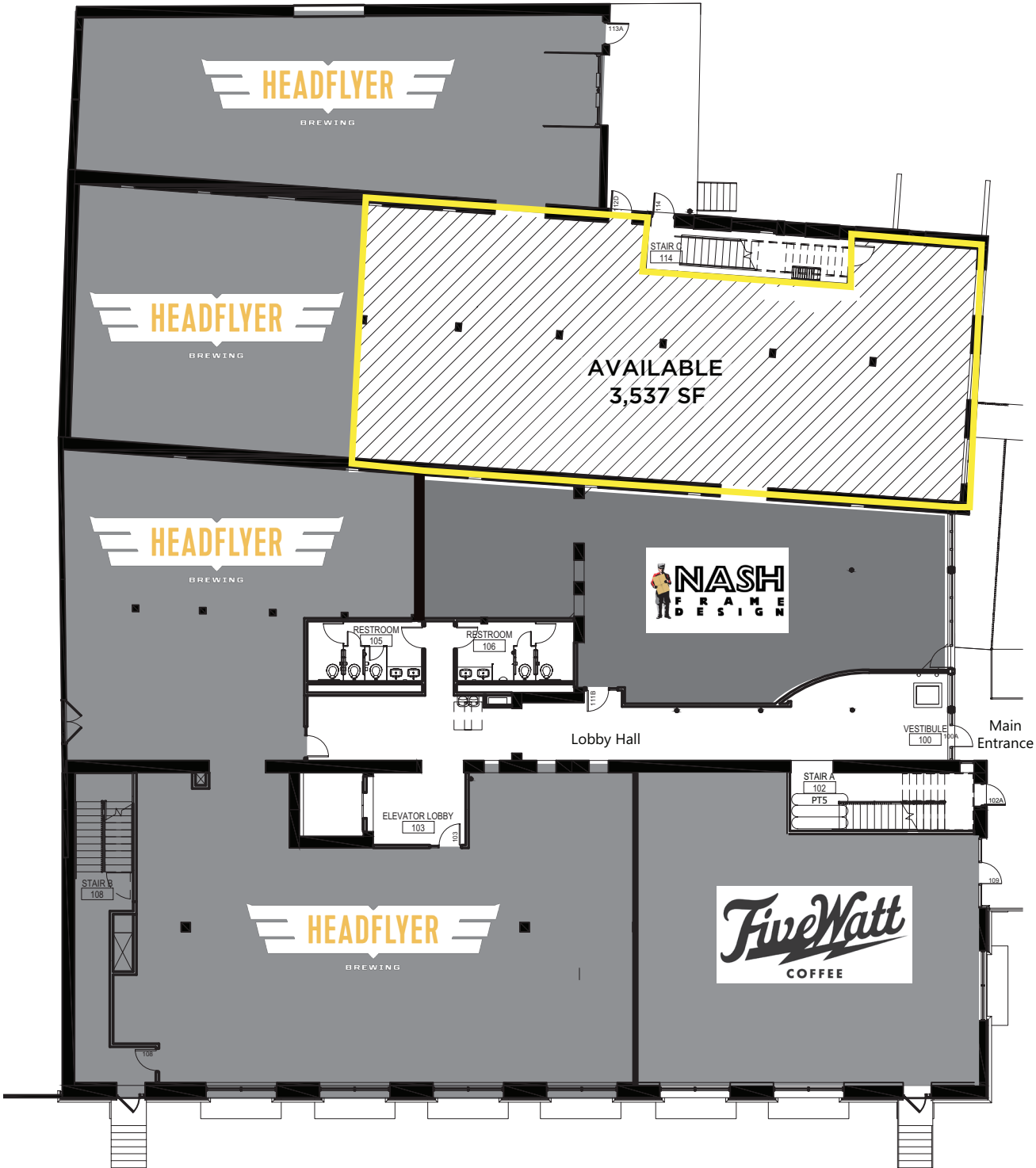

Hennepin Ave.



# Second Floor Plan

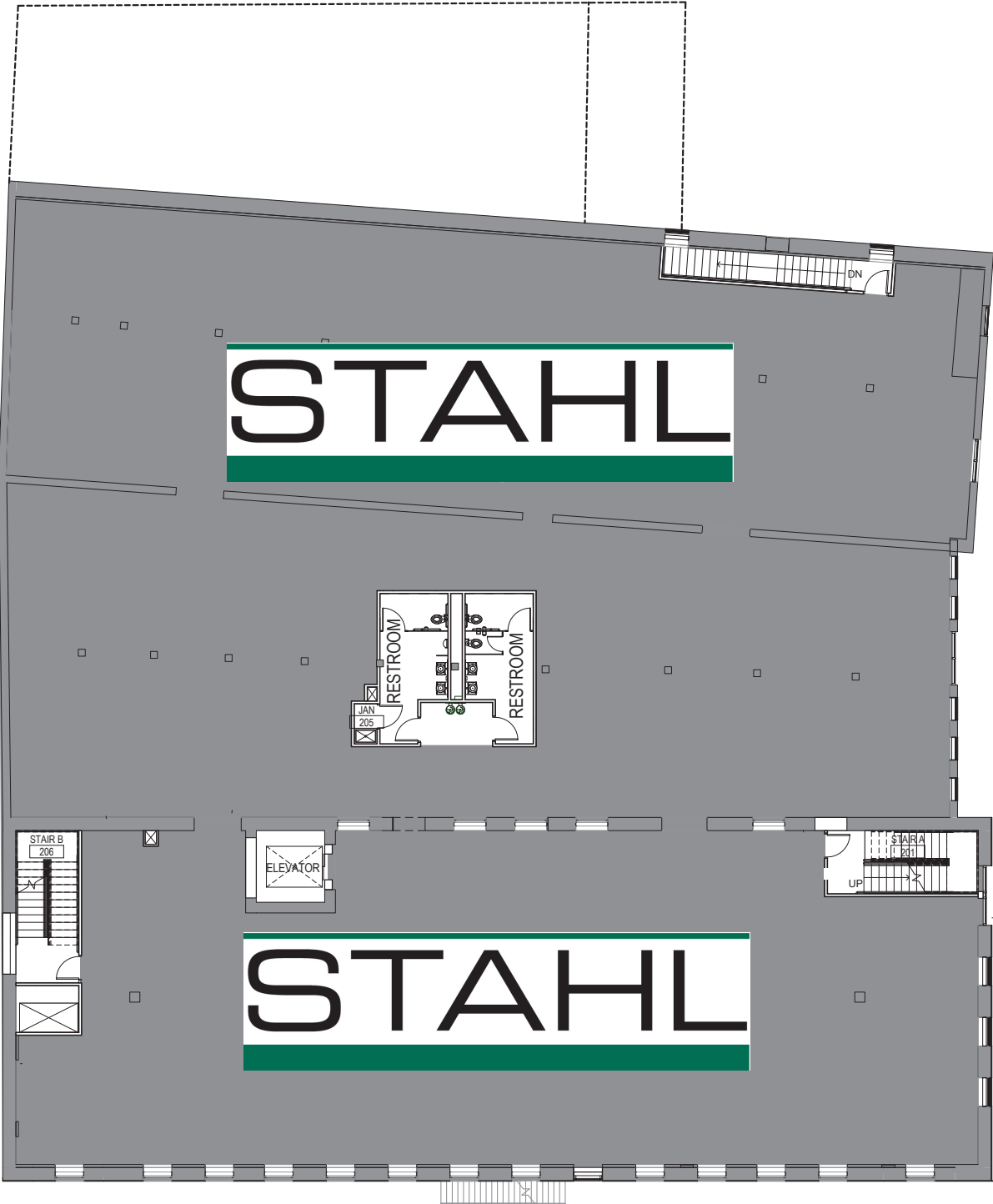



# Third Floor Plan

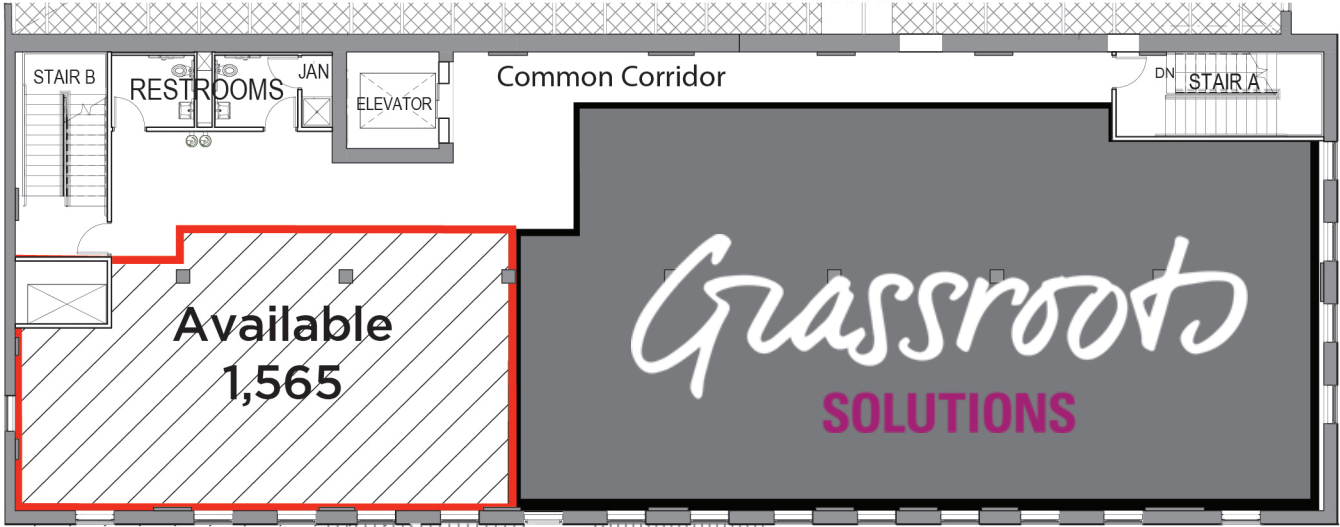

# Fourth Floor Plan

